

Metal

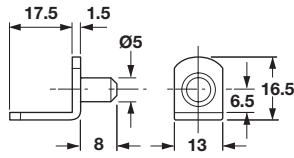

Ø5 mm

- Angular, with riveted pin

Material: Steel

Finish	Item No.
brass-plated	282.11.501
nickel-plated	282.11.707

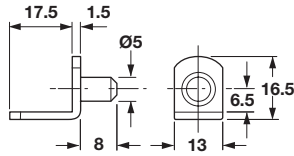

Ø5 mm

- Angular, with riveted pin and securing screw hole

Material: Steel

Finish	Item No.
brass-plated	282.11.510
nickel-plated	282.11.710
bronzed	282.11.110

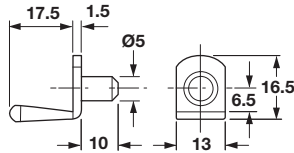

Ø5 mm

- Angular, for glass shelves
- With riveted pin and protective cover

Material: Steel; Cover: Plastic; Color: brown

Finish	Item No.
brass-plated	282.11.120

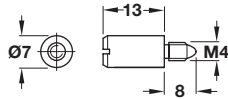

With M4 Thread

- Screw mounts in expanding sleeve
- Weight capacity: 80 kg (175 lbs.)

Material: Steel

Finish	Item No.
nickel-plated	282.39.705

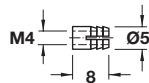

Expanding Sleeve

- With M4 internal thread
- For Ø5 mm drill hole

Material: Brass, bright

	Item No.
	051.45.004