

# FR 5001.ECD

<b>SLIDE TYPE:</b>	Full-Extension Ball Bearing Drawer Slide - with Easy Close Device
<b>MOUNTING:</b>	Side Mount

<b>WIDTH:</b>	12.3 mm (0.48 in.)
<b>LOAD CAPACITY:</b>	dynamic up to 45 kg (100 lbs.)

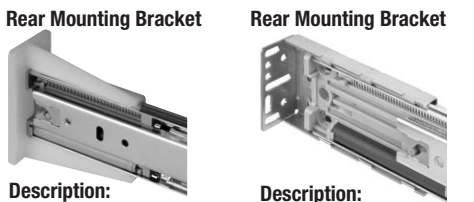
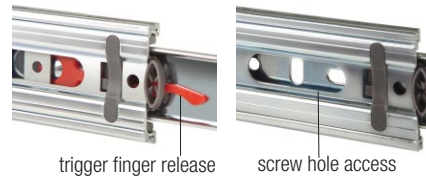
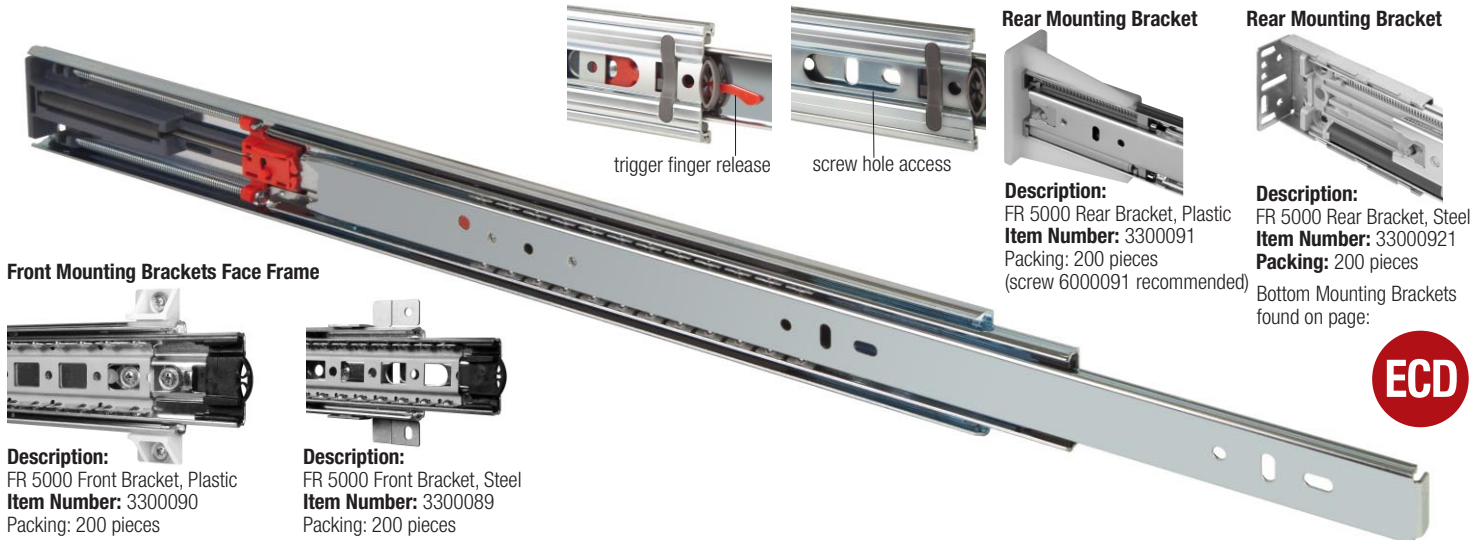

**Front Mounting Brackets Face Frame**

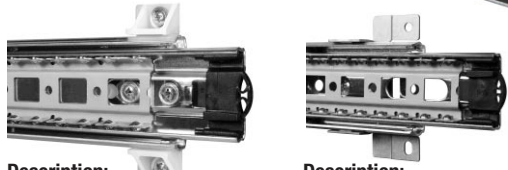

**Description:**  
FR 5000 Front Bracket, Plastic  
**Item Number:** 3300090  
Packing: 200 pieces

**Description:**  
FR 5000 Front Bracket, Steel  
**Item Number:** 3300089  
Packing: 200 pieces

**Description:**  
FR 5000 Rear Bracket, Plastic  
**Item Number:** 3300091  
Packing: 200 pieces  
(screw 6000091 recommended)

**Description:**  
FR 5000 Rear Bracket, Steel  
**Item Number:** 33000921  
Packing: 200 pieces  
Bottom Mounting Brackets found on page:



<b>MATERIALS:</b>	cold rolled steel
-------------------	-------------------

<b>FEATURES:</b>	steel ball bearings
------------------	---------------------

<b>SPECIFICATIONS:</b>	<ul style="list-style-type: none"> <li>▶ precision ball bearing drawer slide for medium-duty applications in office and residential furniture</li> <li>▶ drawer profile features an easy to operate disconnect finger release trigger</li> <li>▶ system 32 compatible hole locations</li> <li>▶ drawer slide is non-handed</li> <li>▶ new ECD Easy Close Device</li> </ul>
------------------------	--

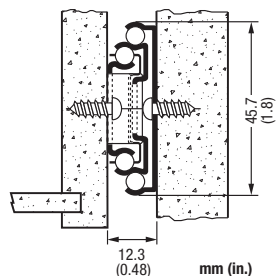

12.3 mm (0.48 in.) is the actual size of the slide. Allow a min. of 12.8 mm (0.50 in.) for clearance and a maximum of 13.3 mm (0.52 in.).



**FR 5000 Bottom Mounting Bracket**  
Steel, height 11mm  
**Item Number:** 3300101  
Steel, height 21mm  
**Item Number:** 3300103  
Packing: 200 pieces

**FR 5000 Front Mounting Bracket for Face Frame with offset**  
Steel, offset 20mm  
**Item Number:** 3300105  
Packing: 200 pieces

<b>NOTE:</b>	▶ The compatible regular extension sister model FR 5005
--------------	---

<b>CAUTION:</b>	<ul style="list-style-type: none"> <li>▶ Temperature range 5°C-40°C (41°F-104°F)</li> <li>▶ For a rigid connection of the front and rear face frame mounting brackets we recommend the use of truss head screw 6000091. See screws page.</li> <li>▶ We do not recommend this slide to be used on drawers over 27 in. in width. Use FR 5050.ECD, FR 5210.ECD or FR 5609.ECD instead.</li> </ul>
-----------------	--

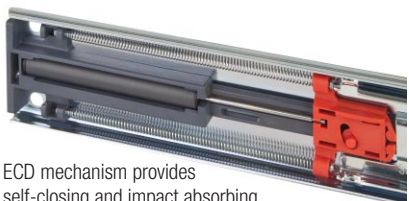

ECD mechanism provides self-closing and impact absorbing soft-close feature.

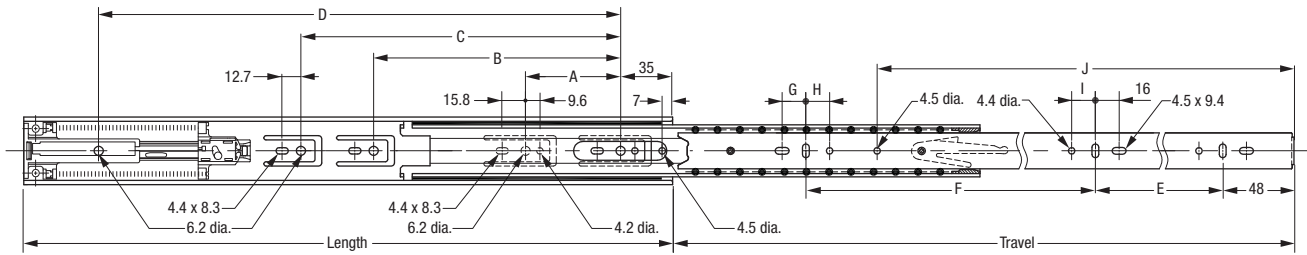

Length	Travel	Cabinet Profile:				Drawer Profile:						Weight	Order No. zinc												
		A	B	C	D	E	F	G	H	I	J														
mm	in	mm	in	mm	in	mm	in	mm	in	mm	in	mm	in	kg.	lbs.										
300	11.81	245	9.65	64	2.52			224	8.82					16	0.63	189	7.44	*	400920						
355	13.98	350	13.78	64	2.52	128	5.04			288	11.34	128	5.04					*	400921						
405	15.95	400	15.75	64	2.52	160	6.30			320	12.60	160	6.30					*	400922						
450	17.72	450	17.72	64	2.52	224	8.82			352	13.89	160	6.30					*	400923						
500	19.69	500	19.69	64	2.52	256	10.08			416	16.38	192	7.56	128	5.04	16	0.63	16	0.63	16	0.63	*	400924		
550	21.65	550	21.65	64	2.52	224	8.82	320	12.60	448	17.64	224	8.82	160	6.30					16	0.63	16	0.63	*	400925
600	23.62	600	23.62	64	2.52	224	8.82	352	13.86	512	20.16	256	10.08	160	6.30	16	0.63	16	0.63	16	0.63			*	400926
650	25.59	650	25.59	64	2.52	224	8.82	416	16.19	576	22.68	256	10.08	192	7.56	16	0.63	16	0.63	16	0.63			*	400927
700	27.56	700	27.56	64	2.52	224	8.82	448	17.69	608	23.94	288	11.34	224	8.82	16	0.63	16	0.63	16	0.63			*	400928

Packing Unit: 10 pair per box

\* on request

